

SPRING CLAMP TERMINAL BLOCKS, PLUGGABLE, 5.00mm PITCH

SPRING CLAMP TERMINAL BLOCKS, PLUGGABLE, 5.00mm PITCH



Product family Pole size Color Option
SP025xxHDNC *(ASP025)
 Centerline Design Function *old product name

- spring clamp terminal block, pluggable
- centerline 5.00 mm, direction of connection 90°
- fittable without loss of poles
- color gray
- eccentric lever, wire entry perpendicular to plug direction

Technical data

300 V / A / AWG	300 / 8 / 28 - 16		
10 A / 250 V / 2.5 kV / 3 / 0.08 - 1.5 mm ² / IEC 61984			
Overvoltage category	III	III	II
Pollution degree	3	2	2
Rated voltage	250 V	500 V	500 V
Rated test voltage	4.0 kV	4 kV	4.0 kV
Insulating material class	CTI 400		
Rated wiring solid wire	0.08 - 1.5 mm ²		
Rated wiring stranded wire	0.08 - 0.75 mm ²		
Rated wiring solid wire	AWG 28 - 16		
Rated wiring stranded wire	AWG 28 - 18		
Clearance and creepage distances	3.7 mm		
Protection category according to IEC 60529	IP 20		
Min. insul. strip length	4 mm		
Color	gray		

Dimensional drawing

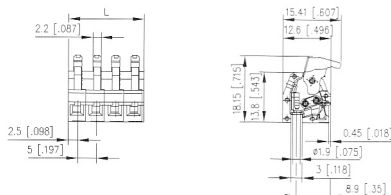

L = (Pole size - 1) * centerline + 5 mm (0.197 in.)

P/N

SP025XXHDNC

Complete the part number
by adding the pole size.

02	03	04	05	06	07	08
09	10	11	12	13	14	15
16	17	18	19	20	21	22
23	24					



Product family Pole size Color Option
SP145xxHBNC *(ASP145)
 Centerline Design Function *old product name

- spring clamp terminal block, pluggable
- centerline 5.00 mm, direction of connection 90°
- fittable without loss of poles
- color black
- push-button, wire entry perpendicular or parallel to plug direction, three plugging directions

Technical data

300 V / A / AWG	300 / 6 / 28 - 16		
13.5 A / 250 V / 4 kV / 3 / 0.08 - 1.5 mm ² / IEC 61984			
Overvoltage category	III	III	II
Pollution degree	3	2	2
Rated voltage	250 V	630 V	630 V
Rated test voltage	2.5 kV	6 kV	4 kV
Insulating material class	CTI 225		
Rated wiring solid wire	0.08 - 1.5 mm ²		
Rated wiring stranded wire	0.08 - 1.5 mm ²		
Rated wiring solid wire	AWG 28 - 16		
Rated wiring stranded wire	AWG 28 - 16		
Clearance and creepage distances	3.2 mm		
Protection category according to IEC 60529	IP 20		
Min. insul. strip length	7 mm		
Color	black		

Dimensional drawing

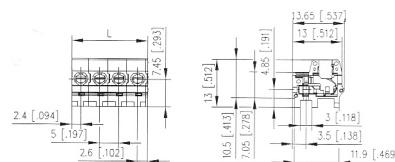

L = (Pole size - 1) * centerline + 5 mm (0.197 in.)

P/N

SP145XXHBNC

Complete the part number
by adding the pole size.

02	03	04	05	06	07	08
09	10	11	12			