

### UNSHIELDED RJ45 TO SUB D MODULAR JACK ADAPTORS

#### TECHNICAL SPECIFICATIONS

Material: UL Recognised Plastic Material  
 Operating Temperature: -30°C to +110°C  
 Thumbscrews: UNC 4-40 (standard)

Size	Dim A	Dim B	Dim C
9-way	33,0	15,0	49,5
15-way	41,3	15,0	39,0
25-way	55,1	15,0	39,0

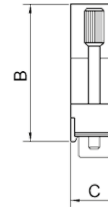
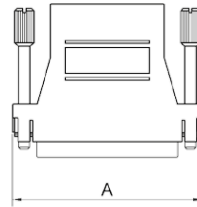

Size	D Gender	Black	Light Grey	Blue	Green	Yellow	Red
9	Female	DA9-SMJ8-K	DA9-SMJ8-LTGREY-K	DA9-SMJ8-BLUE-K	DA9-SMJ8-GREEN-K	DA9-SMJ8-YELLOW-K	DA9-SMJ8-RED-K
9	Male	DA9-PMJ8-K	DA9-PMJ8-LTGREY-K	DA9-PMJ8-BLUE-K	DA9-PMJ8-GREEN-K	DA9-PMJ8-YELLOW-K	DA9-PMJ8-RED-K
15	Female	DA15-SMJ8-K	-	-	-	-	-
15	Male	DA15-PMJ8-K	-	-	-	-	-
25	Female	DA25-SMJ8-K	DA25-SMJ8-LTGREY-K	DA25-SMJ8-BLUE-K	DA25-SMJ8-GREEN-K	DA25-SMJ8-YELLOW-K	DA25-SMJ8-RED-K
25	Male	DA25-PMJ8-K	DA25-PMJ8-LTGREY-K	DA25-PMJ8-BLUE-K	DA25-PMJ8-GREEN-K	DA25-PMJ8-YELLOW-K	DA25-PMJ8-RED-K

### UNSHIELDED RJ12 TO SUB D MODULAR JACK ADAPTORS

#### TECHNICAL SPECIFICATIONS

Material: UL Recognised Plastic Material  
 Operating Temperature: -30°C to +110°C  
 Thumbscrews: UNC 4-40 (standard)

Size	Dim A	Dim B	Dim C
9-way	33,0	15,0	49,5
15-way	41,3	15,0	39,0
25-way	55,1	15,0	39,0

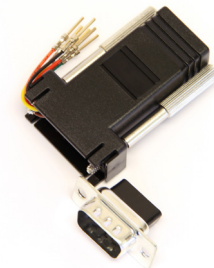
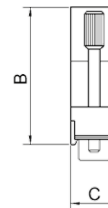
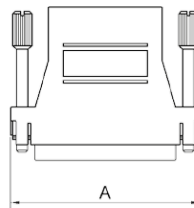

Size	Gender	Black
9	F	DA9-SMJ6-K
9	M	DA9-PMJ6-K
25	F	DA25-SMJ6-K
25	M	DA25-PMJ6-K

### SHIELDED RJ45 TO SUB D MODULAR JACK ADAPTORS

#### TECHNICAL SPECIFICATIONS

Material: UL Recognised Plastic Material  
 Plating: Nickel over Copper  
 Operating Temperature: -30°C to +90°C  
 Thumbscrews: UNC 4-40 (standard)

Size	Dim A	Dim B	Dim C
9-way	33,0	15,0	49,5
15-way	41,3	15,0	39,0
25-way	55,1	15,0	39,0

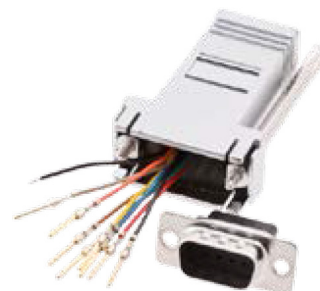
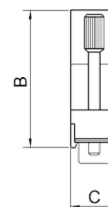
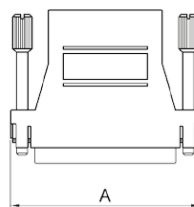

Size	Gender	Black
9	F	DA9-SMJ8-M-K
9	M	DA9-PMJ8-M-K
25	F	DA25-SMJ8-M-K
25	M	DA25-PMJ8-M-K