

NICKEL, SCREW TOGETHER HOODS, CLAMP

DM SERIES

TECHNICAL SPECIFICATIONS

Material: Zinc, Nickel Plated
 Operating Temperature: -40°C to +120°C
 Cable Entry: Top Entry
 Thumbscrews: UNC 4-40 (standard)
 Cable Diameter: M2.5, M2.6 or M3.0 on request
 Up to 13 mm

FEATURES

- Available in sizes 9-15-25-37
- 360° EMI Shielding
- Suitable for any common Sub-D connector
- Supports all types of cables
- Quick assembly

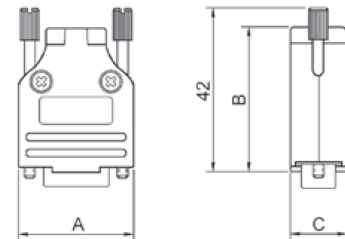

Size	Product Code
9-way	DM9-K
15-way	DM15-K
25-way	DM25-K
37-way	DM37-K

Size	Dim A	Dim B	Dim C
9-way	32,2	41,3	15,4
15-way	40,6	43,3	15,4
25-way	54,5	49,5	15,4
37-way	70,7	54,3	15,4

NICKEL, SCREW TOGETHER HOODS, CLAMP, 35° ENTRY

DM35 SERIES

TECHNICAL SPECIFICATIONS

Material: Zinc, Nickel Plated
 Operating Temperature: -40°C to +120°C
 Cable Entry: Side Entry
 Thumbscrews: UNC 4-40 (standard)
 Cable Diameter: M2.5, M2.6 or M3.0 on request
 Up to 13 mm

FEATURES

- Available in sizes 9-15-25-37
- 360° EMI Shielding
- Suitable for any common Sub-D connector
- Supports all types of cables
- Quick assembly

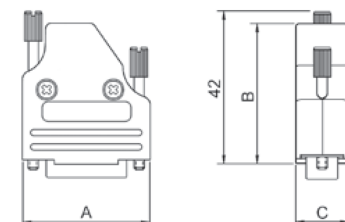

Size	Product Code
9-way	DM35-9-K
15-way	DM35-15-K
25-way	DM35-25-K
37-way	DM35-37-K

Size	Dim A	Dim B	Dim C
9-way	43,0	32,0	15,5
15-way	43,0	40,4	15,5
25-way	48,0	54,0	15,5
37-way	53,0	70,5	15,5